

5th February 2009

Mr. A. Walker-Robson
DP9
100 Pall Mall
London
SW1Y 5NQ



BRUCESHAW
COST MANAGERS
VALUE ENGINEERS
PROJECT MANAGERS

BY EMAIL AND POST

**BRUCESHAW
PARTNERSHIP**
CHARTERED
QUANTITY SURVEYORS
ARTILLERY HOUSE
11-19 ARTILLERY ROW
LONDON SW1P 1RT
TEL: 144 (0)20 7799 1100
FAX: 144 (0)20 7799 1101
LONDON@BRUCESHAW.CO.UK
WWW.BRUCESHAW.CO.UK

Dear Alex,

10 Trinity Square, London
Addendum to Construction Method Statement
To be read in conjunction with Construction Method Statement, November 2008

We are writing to you following the amendment to the Planning Submission for the development at 10 Trinity Square, London. We can confirm that the amendments are related to Seething Lane Garden are as follows: -

- Pavilion to the North: - This pavilion now houses the double vehicle lifts, which have been moved from the South Pavilion.
- Pavilion to the South: - The vehicle lifts are moved to the North as described above. The builders hoist has been relocated from the North to the South pavilion.

For the above items the only change to our Construction Method Statement, November 2008 is the revision of Diagrams 1, 2 and 3, which we enclose for inclusion in the planning amendment.

We trust the above is clear.

Yours sincerely,

Kieran Rothery
Bruce Shaw Partnership

Encl. Updated Diagrams 1, 2 & 3

LONDON/BELFAST

PARTNERS
P. J. CLEARY MRICB
P. J. O'ARCY MRICB
W. F. R. COLLINS FRICB
P. J. BODDY MRICB
R. C. DALRYMPLE MRICB
R. FOGARTY MRICB
G. DUNNE MRICB
C. PATRICK MRICB
R. A. GALLAGHER ICIIB
J. B. MCELWAIN ICIIB
E. W. BOAL MRICB
J. G. HENDERSON MRICB
A. D. MURRAY MRICB
D. J. WILSON MRICB

SENIOR ASSOCIATE
K. ROTHERY MRICB

ASSOCIATES
P. FARROW MRICB
A. GANNON MRICB
E. THOMLINSON MRICB
J. SURREN MRICB
D. F. MCGURK MRICB

TRAINING CONSULTANT
A. S. MORRIS LLW



Diagram 1 (Page 5 of 16)

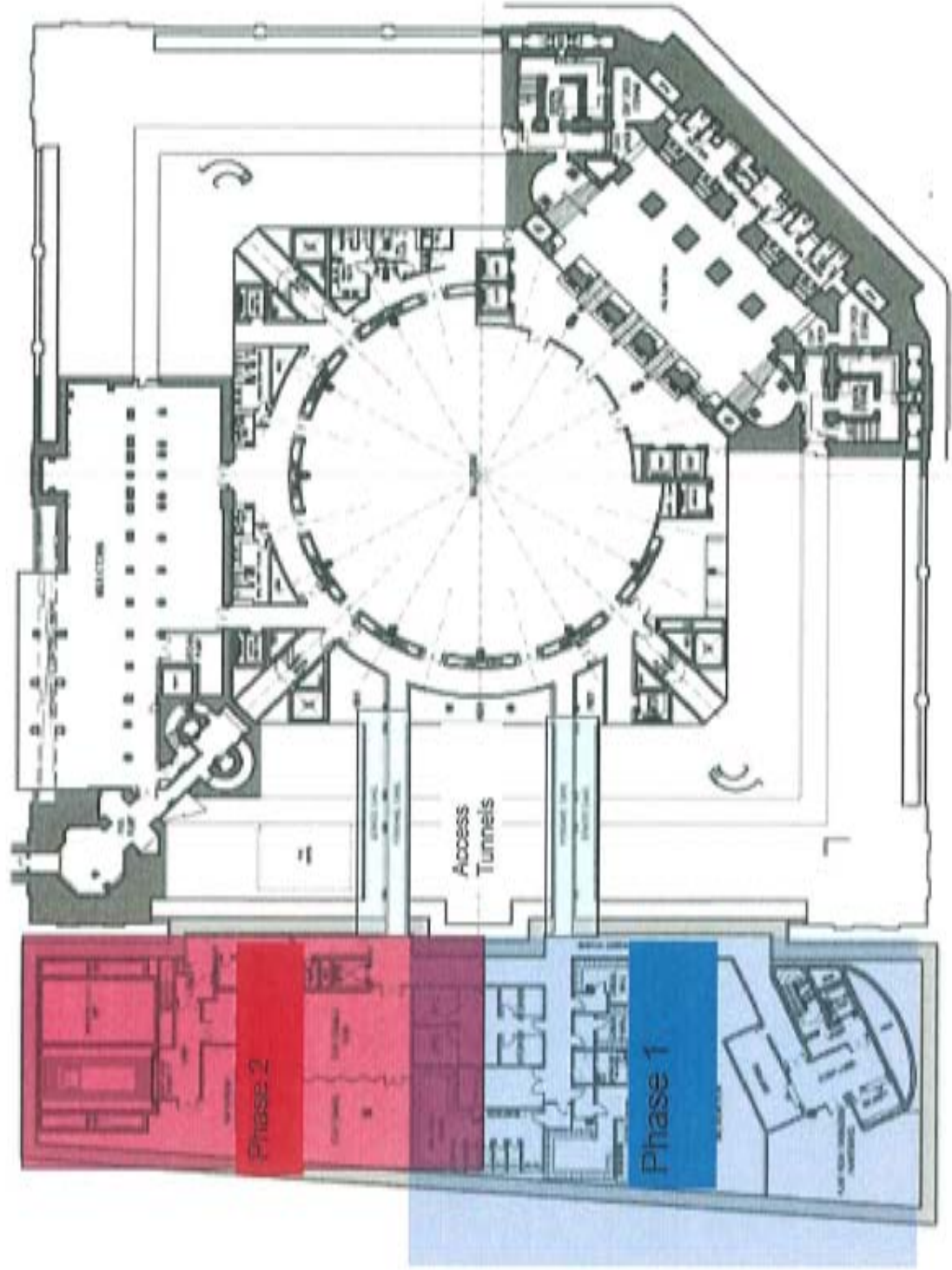
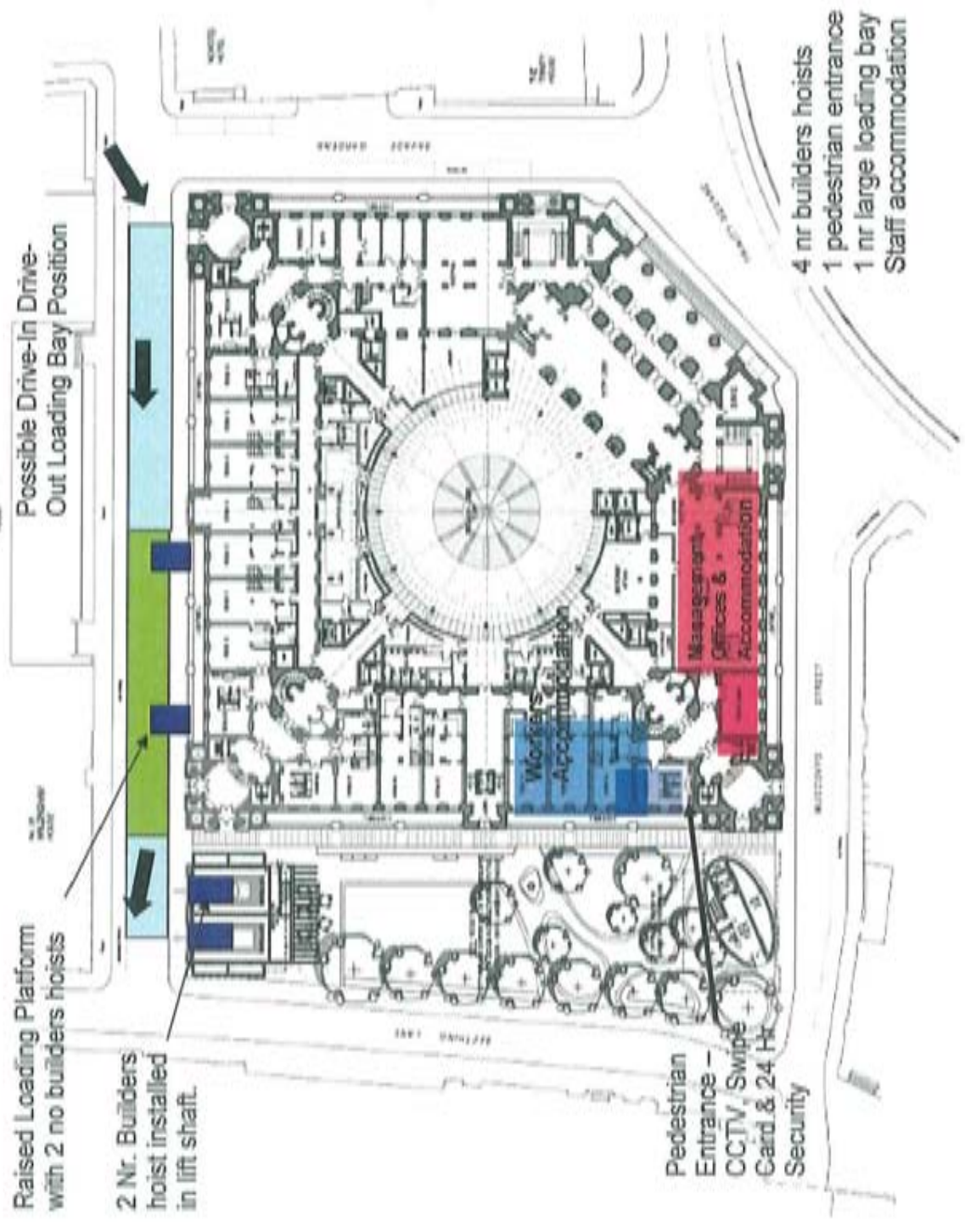



Diagram 2 (Page 7 of 16)



- 4 nr builders hoists
- 1 pedestrian entrance
- 1 nr large loading bay
- Staff accommodation

10 TRINITY SQUARE, LONDON
ADDENDUM TO CONSTRUCTION METHOD STATEMENT
To be read in conjunction with Construction Method Statement, November 2008

Diagram 3 (Page 8 of 16)

